

Do not use with water that is microbiologically unsafe or of unknown quality without adequate disinfection before or after the system.



Tested and Certified by NSF International against NSF/ANSI Standard 42, 53 and 401 in model HF-3STAGE for the reduction of the claims specified on the Performance Data Sheet as verified and substantiated by test data and at www.nsf.org.

REPLACEMENT

- Conforms to NSF/ANSI Standards 42, 53 and 401 for substances listed on the performance data sheet. See performance data sheet for individual contaminants and reduction performance at: www.hahnfiltration.com
- Systems certified of cyst reduction may be used on disinfected waters that may contain filterable cysts.
- Rated capacity: 600 gallons / 2,271 liters

Thank you for choosing HAHN Filtration!



Manufactured by Sink Warehouse, LP
4601 Spicewood Springs Rd, Suite 1-100, Austin, Texas 78759
(888) 245-3114 • www.hahnfiltration.com

HF-3-R_INST_201403



Replacement Cartridge Instructions

MODEL HF-3-R for use with HF-3STAGE

1. Shut off the cold water valve under the sink. Release the pressure from the system by turning on the filtration system faucet. Once there is no longer any water coming from the filtration system faucet, you will be ready to change the filters.

2. Unpack the replacement filter cartridges from the box & remove the plastic wrap from the filters. You will notice that each filter cartridge is color coded to match the cartridge sump on the filtration system.

3. Remove each cartridge sump from the filtration system by rotating the sump towards the left side & pull down to detach. (Figure A)

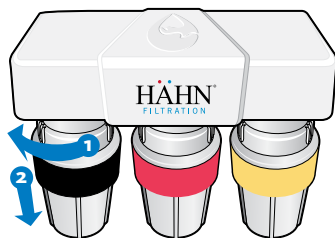

FIGURE A

4. Hold the cartridge sump over the sink, separate the two pieces of the sump by twisting the bottom portion of the sump away from the top, as shown. Pour any excess water down the drain. Pull down on each cartridge to disconnect the filter cartridge from the top half of the sump. (Figure B)

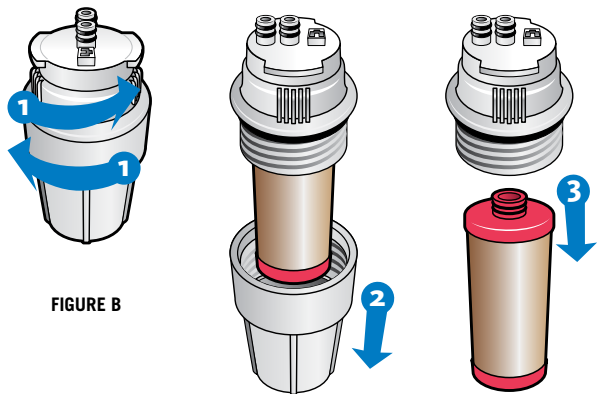

FIGURE B

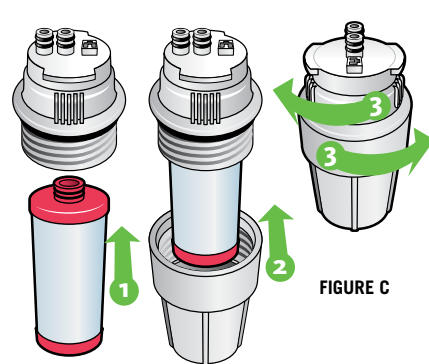

FIGURE C

5. Insert & connect the new filter cartridge to the top half of the sump then reattach the bottom of the sump to the top half by turning & tightening clockwise. (Figure C)

6. Reattach sump to the bottom of the top housing by making sure all connection points are aligned, pushing the top of the sump up & into the bottom of the top housing & turning the sump towards the right. Ensure that the sump is fully attached and locked in. Black on left, Red in the middle, yellow on right. (Figure D)

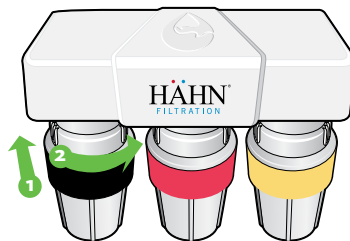

FIGURE D

7. Open battery door and remove old battery. Place new battery in, positive side facing to the back. When inserted properly, your system will beep (5) times and blink red. (Figure E)
8. Once all filter cartridges have been changed and sums are securely attached to the top housing, slowly turn the cold water valve back on. Turn off the filtration system faucet & inspect the filtration system for leaks.
9. Allow the filtered water to run 10 minutes before drinking.



FIGURE E